

FLUIDO+ 70

KIT PINZE- CLAMPS KIT

MAX 70 Kg- 154 lbs

Porte - Doors

B070EK10



- Kit coppia pinze con chiave
- Kit par de pinzas con llave
- Kit with pair of clamps with key
- Bausatz ein Paar Zangen mit Schlüssel
- Kit paire de pinces avec clé

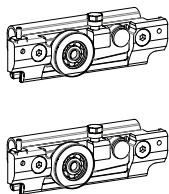

B070EK05



- Kit coppia pinze falso soffitto
- Kit par de pinzas a cielo falso
- Kit with pair of clamps on false ceiling.
- Bausatz ein Paar Zangen an abgehängter Decke.
- Kit paire de pinces faux-plafond.

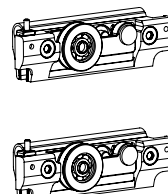

B150EK3NN



- Kit coppia Retainer. Stop meccanico
- Kit par tope mecánico
- Kit with pair of mechanical stops
- Bausatz ein Paar mechanische Stopper
- Kit paire arrêt mécanique

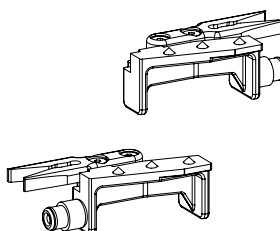

B070EK3SS



- Kit coppia Soft Close CPCS
- Kit par Soft Close CPCS
- Kit with Soft Close CPCS pair
- Bausatz ein Paar Soft Close CPCS
- Kit paire Soft Close CPCS

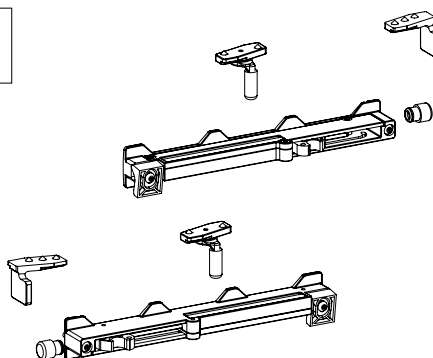

B110EK66 !

SOSTITUIRÀ - IT WILL REPLACE B110EP73 / B110EP74
disponibili fino esaurimento scorte - available while stocks last

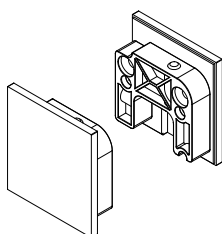

- Coppia di tappi.
- Par de tapones
- Pair of caps
- Paar Kappen
- Paire de bouchons

B110EK67 !

SOSTITUIRÀ - IT WILL REPLACE B110EP75 / B110EP76
disponibili fino esaurimento scorte - available while stocks last

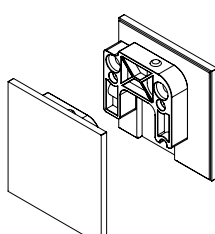

- Coppia di tappi per versione con fisso laterale.
- Par de tapones para versión con cristal fijo lateral
- Pair of caps for model with side fixed glass
- Paar Kappen für Version mit festem Seitenglas
- Paire de bouchons pour version avec vitrage fixe latéral

B150EK68 !

SOSTITUIRÀ - IT WILL REPLACE B110EP64 / B110EP77
disponibili fino esaurimento scorte - available while stocks last

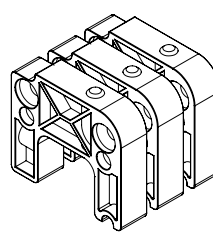

- Spessore per Veletta e supporti laterali
- Consigliato per binari oltre i 2,5m
- Cuña para panel y soportes laterales
- Aconsejado para perfiles de largo superior a 2,5 m
- Spacer for casing and side fittings
- Recommended for rails longer than 2,5 m
- Distanzstück für Anlauf und Seitenträger
- Empfohlen für Profilen über 2,5 m
- Épaisseur pour panneau et supports latéraux
- Recommandé pour les profils de plus de 2,5 m