

8201 TRILOBA

colcom
OILDYNAMIC • REGOLABILE / ADJUSTABLE

MAX 150 Kg - 330 lbs

Porte - Doors

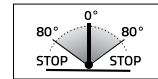
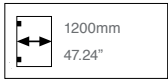

- Cerniera oleodinamica inferiore con regolazione delle velocità di chiusura dell'anta. Stop a 0° +90° -90°.
- Bisagra automática hidráulica inferior con regulación de velocidad de cierre de la puerta. Stop a 0°, +90°, -90°.
- Bottom hydraulic hinge with adjustment of the closing speed of the door. Stop at 0° +90° -90°.
- Selbstschließendes unteres Hydraulikband mit Regelung der Schließgeschwindigkeit und Feststellung +/-90°.
- Charnière hydraulique avec réglage de la vitesse de fermeture du battant. Arrêt à 0°, +90° et -90°.



Alluminio / Aluminium :02-05-13-14-15-16-17-RAL-62



APERTURE VIOLENTE OLTRE I 95° POTREBBERO CAUSARE LO SCARDINAMENTO. È CONSIGLIABILE L'APPLICAZIONE DI UN FERMAPORTA
VIOLENT OPENING FURTHER THAN 95° COULD UNHINGE THE DOOR.
WE SUGGEST TO INSTALL A DOOR STOPPER



Per installazioni in condizioni ambientali e climatiche particolari (es. Umide, acide, saline), consultare prima l'ufficio commerciale
For installations in particular environments or climate (ex. Wet, acid, saline) consult sales office first

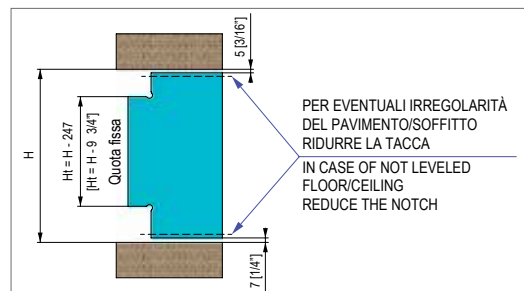
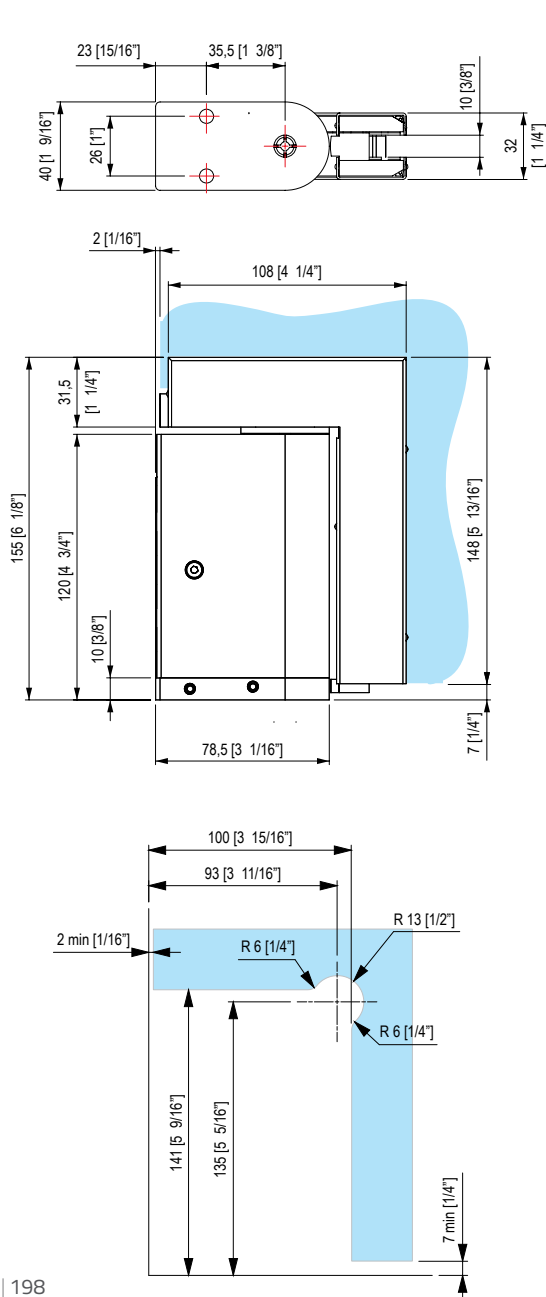

Classificazione secondo normativa - Clasificación según la ley - Classification according to int'l regulation
Klassifizierung nach den Vorschriften - Classification selon la norme

art. 8201	UNI EN 1154 : 2006	3	8	³ / ₆	0	1	4
-----------	--------------------	---	---	-----------------------------	---	---	---

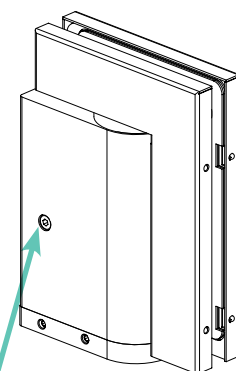
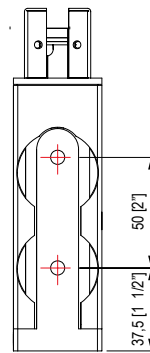

Ugello di regolazione della velocità' di chiusura della porta.
Válvula de ajuste de la velocidad de cierre de la puerta.
Control valve for the closing speed of the door.
Regelventil für die Türschließgeschwindigkeit.
Valve de réglage de l'intensité de freinage.